

# Cold Foam Asphaltic Concrete

*"We Lay the Groundwork for Success"*



Cold foam in-place recycled asphaltic concrete (CFA) is now a well established methodology for in-place recycling of distressed pavements with a successful track record of completed projects throughout California. This track record includes many general engineering and specialty subcontractors with experience in conventional uses of CFA. Initially, projects in California were most commonly applied to rural applications, with Caltrans using CFA successfully on numerous rural highways in Northern and Southern California.

Condor has experience on the largest CFA projects in Northern California. These include several major projects in the City of Chico, as well as projects within Yolo and San Joaquin Counties. Condor has performed these services on rural roads without vertical control on the shoulders, as well as city multi-lane and divided streets with vertical control at the medians and curbs. In addition to CFA full depth reconstruction of roadways, Condor has provided alternative full depth reconstruction using lime and cement stabilization when the pavement and subgrade conditions indicate that CFA is not a feasible solution. Complimented by Condor's design and construction quality assurance experience, Condor owns and operates its own in-house CFA mix design testing apparatus. This project experience combined with in-house mix-design capability makes Condor a leader in pavement recycling using CFA.

For those unfamiliar with the basic procedure, it consists of grinding and pulverizing of the existing pavement section and the addition of "foam" bituminous materials, followed by compaction using conventional compaction equipment (sheepsfoot compactor, steel drum roller, pneumatic rollers) to construct a new stabilized base over which an asphaltic concrete (AC) overlay is applied. Typical treatment depths vary from 6 to 12 inches, with typically 2 to 4 inches of AC overlay to complete the project.



CONDOR COLD FOAM ASPHALTIC CONCRETE

**CONDOR EARTH TECHNOLOGIES, INC.**

**An Employee Owned Company**

Sonora - Stockton - Merced

800.800.0490

**[WWW.CONDOR.EARTH.COM](http://WWW.CONDOR.EARTH.COM)**



# Cold Foam Asphaltic Concrete

Where existing pavement sections are thin, CFA sections can be designed to incorporate stabilized sub-grade materials or added aggregates. CFA is well suited to significantly increased traffic capacity, while providing the “green” benefits of a recycled product.

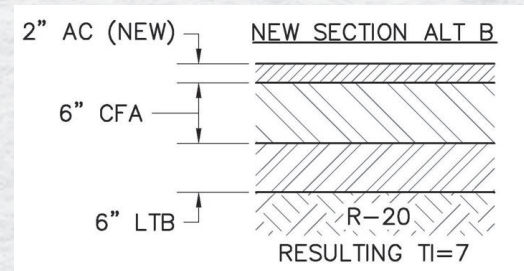
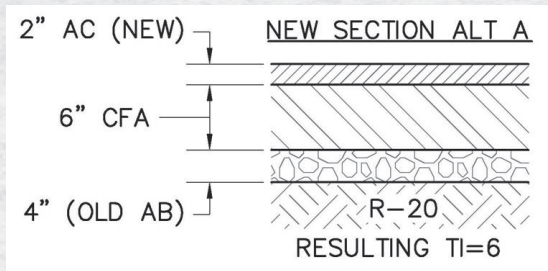
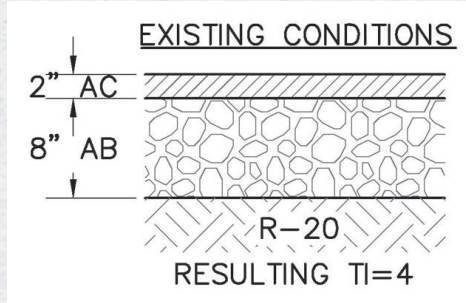

While the application of CFA in California is still not common, successful projects where CFA has successfully been implemented can be shown by example. The following is a partial list of relevant projects:

- City of Chico, East Avenue (ASCE Award Project)
- City of Chico, California Park Drive
- City of Chico, 20th Street
- City of Chico, Manzanita Avenue
- City of Chico, 5th Avenue
- City of Chico, Sherman Avenue
- City of Chico, Forest Avenue
- City of Chico, Mangrove Avenue
- City of Chico, Cohasset Road
- City of Chico, Skyway
- County of Yolo, County Road 99
- County of Yolo, County Road 102
- County of Yolo, County Road 21A
- County of Tulare, County Road 96
- City of Merced, Olive Avenue
- City of Stockton, Stage Coach Road
- City of Ripon, Jack Tone Road
- Mountain House Community Services District, Mountain House Parkway
- City of Porterville, Henderson Avenue- Phase I
- City of Stockton, Arch-Airport Road



**CONDOR EARTH TECHNOLOGIES, INC.**

**An Employee Owned Company**

Sonora - Stockton - Merced

800.800.0490

**WWW.CONDOR.EARTH.COM**